

PROLIAD

LED LIGHTING

Light quality:

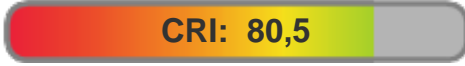

Color temperature:



Output: 4080 lm

Peak: 5370 cd

Power: 47,6 W

PF: 0,95

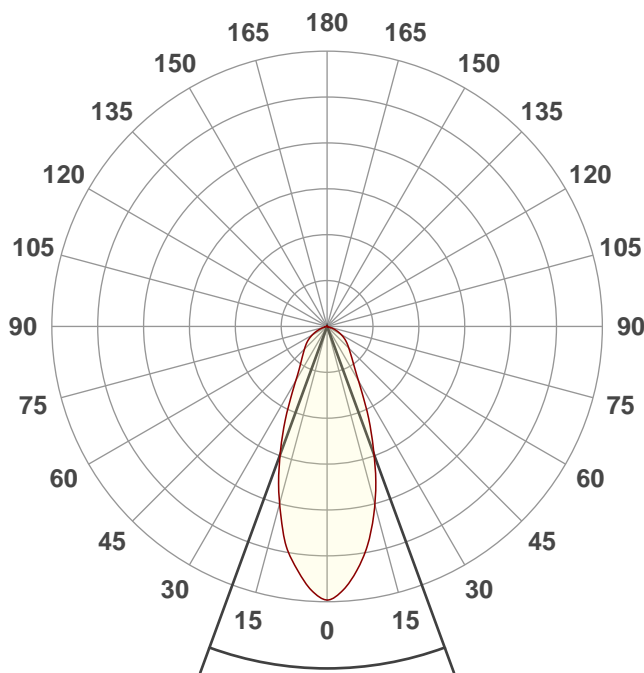

Beam angle

40,2°

Color



CIE1931
x: 0,444
y: 0,410

Spectra

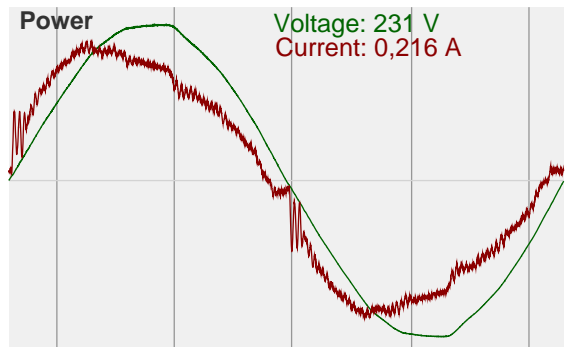
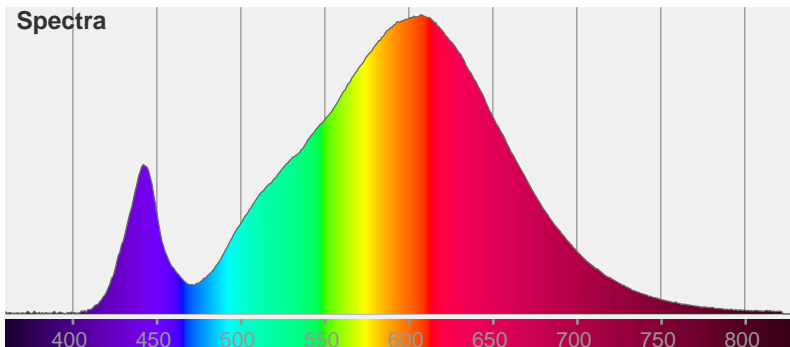

Product name:
**Spotlight XL XTM19503050CCA
AZW38L02**

Date and time:
30-9-2020 12:48:55

Item number:
900 000xxx

Additional information:
**-XTM19803050CCA
-76mm Optic Spot**

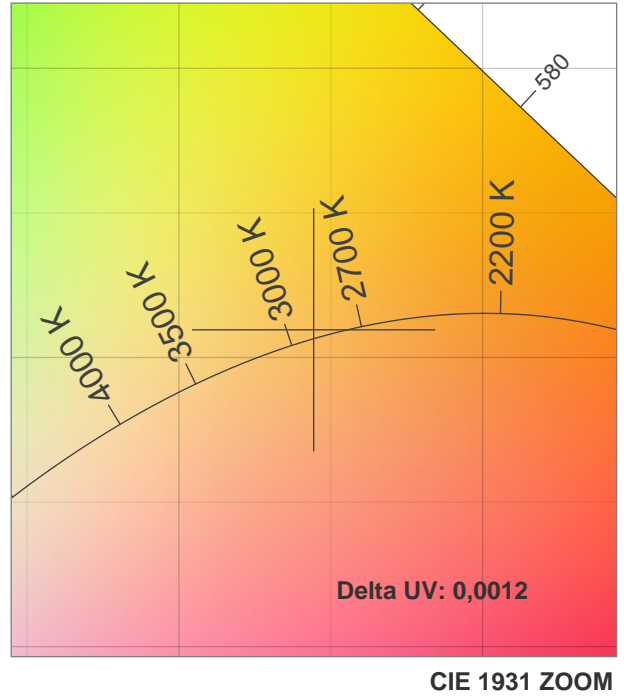
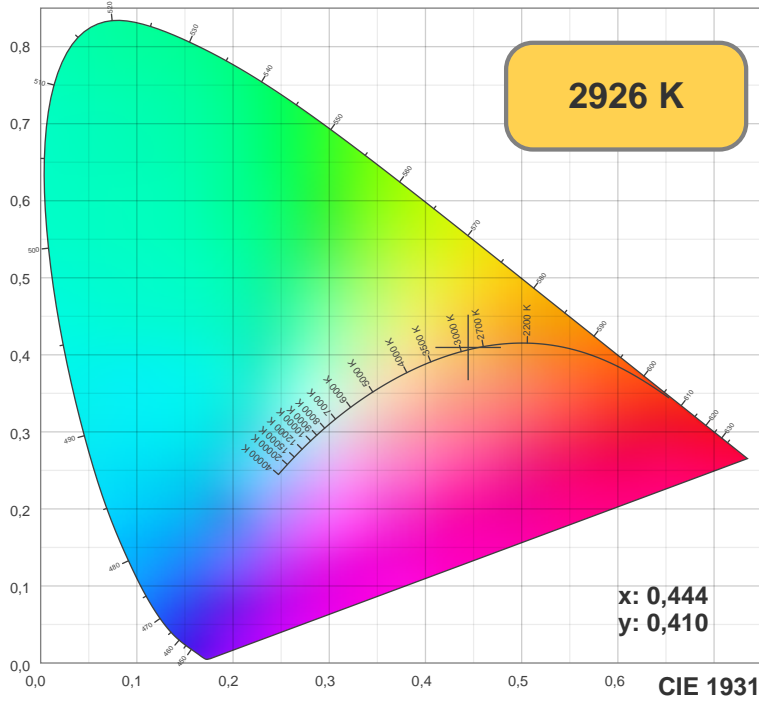

TM30: 78,9

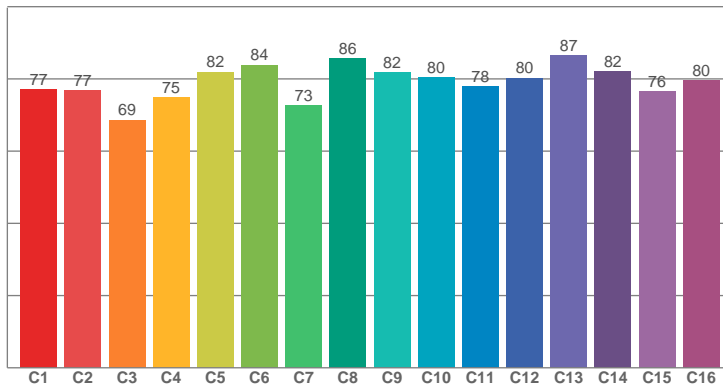

CRI: 80,5 (R1-R8)

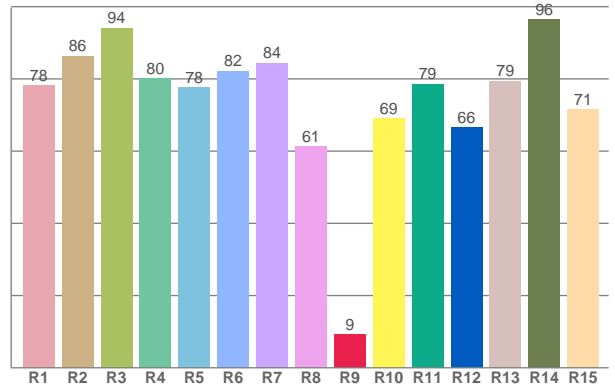

CRI R values, only R1-R8 are used to calculate final CRI value

R1	R2	R3	R4	R5	R6	R7	R8	R9	R10	R11	R12	R13	R14	R15
78,26	86,33	94,14	80,12	77,72	82,18	84,40	61,21	9,21	69,10	78,58	66,50	79,41	96,38	71,49

TM30 C values, 16 binned values out of total of 99 C values

C1	C2	C3	C4	C5	C6	C7	C8	C9	C10	C11	C12	C13	C14	C15	C16
77,01	76,74	68,62	74,88	81,92	83,89	72,63	85,59	81,85	80,47	77,88	80,24	86,53	82,06	76,48	79,61

CQS Q values

Q1	Q2	Q3	Q4	Q5	Q6	Q7	Q8	Q9	Q10	Q11	Q12	Q13	Q14	Q15
73,08	96,51	81,36	78,83	79,12	76,81	79,17	84,81	95,86	85,73	83,43	81,79	81,44	70,35	71,23

CQS: 79,8

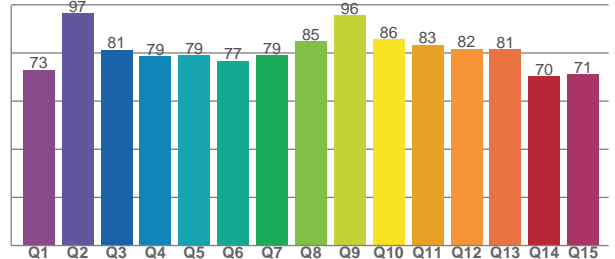

Color parameters

CCT	CRI	CRI R9	TM30 Rf	TM30 Rg	CQS	x	y	u	v	Duv
2926 K	80,5	9,2	78,9	98,8	79,8	0,4	0,4	0,3	0,3	0,0012

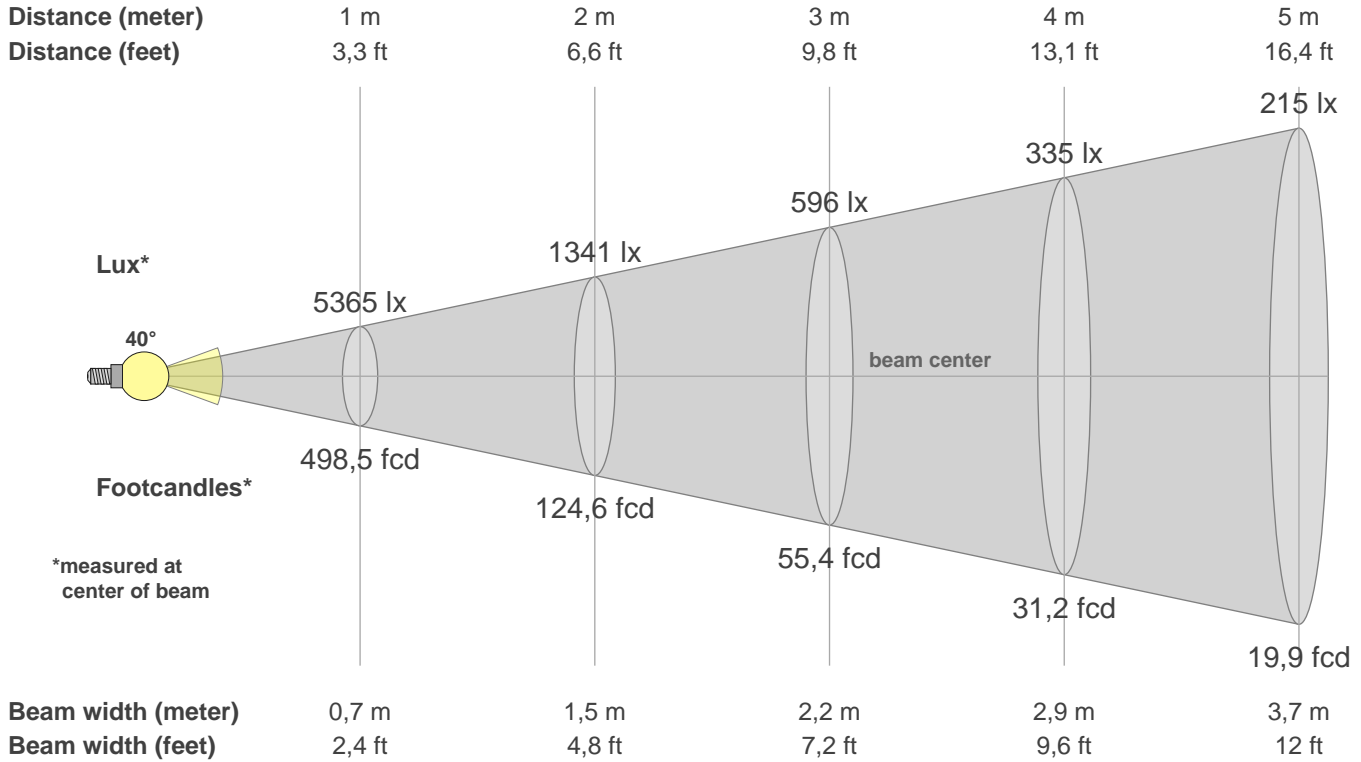

Intensities in 0° c-plane

0°	2°	4°	6°	8°	10°	12°	14°	16°	18°	20°	22°	24°	26°	28°	30°	32°	34°	36°	38°
5365	5264	5130	4923	4689	4430	4119	3794	3444	3085	2708	2360	2035	1734	1450	1250	1082	964	872	793
100%	98%	96%	92%	87%	83%	77%	71%	64%	58%	50%	44%	38%	32%	27%	23%	20%	18%	16%	15%

Intensities in 0° c-plane

0°	2°	4°	6°	8°	10°	12°	14°	16°	18°	20°	22°	24°	26°	28°	30°	32°	34°	36°	38°
5365	5264	5130	4923	4689	4430	4119	3794	3444	3085	2708	2360	2035	1734	1450	1250	1082	964	872	793
100%	98%	96%	92%	87%	83%	77%	71%	64%	58%	50%	44%	38%	32%	27%	23%	20%	18%	16%	15%

Intensities in 180° c-plane

0°	2°	4°	6°	8°	10°	12°	14°	16°	18°	20°	22°	24°	26°	28°	30°	32°	34°	36°	38°
5365	5262	5124	4915	4690	4452	4129	3776	3429	3074	2707	2362	2028	1730	1447	1246	1080	966	880	807
100%	98%	96%	92%	87%	83%	77%	70%	64%	57%	50%	44%	38%	32%	27%	23%	20%	18%	16%	15%

Intensities in 180° c-plane

0°	2°	4°	6°	8°	10°	12°	14°	16°	18°	20°	22°	24°	26°	28°	30°	32°	34°	36°	38°
5365	5262	5124	4915	4690	4452	4129	3776	3429	3074	2707	2362	2028	1730	1447	1246	1080	966	880	807
100%	98%	96%	92%	87%	83%	77%	70%	64%	57%	50%	44%	38%	32%	27%	23%	20%	18%	16%	15%

Beam angle 50%	Field angle 10%	Cutoff angle 2,5%	Intensity ratio in 120° cone	Intensity ratio in 90° cone
40,2°	98,2°	140,3°	92,1%	77,1%

Flicker curve (Complete sampled flicker signal)



Flicker frame (frame of one period)

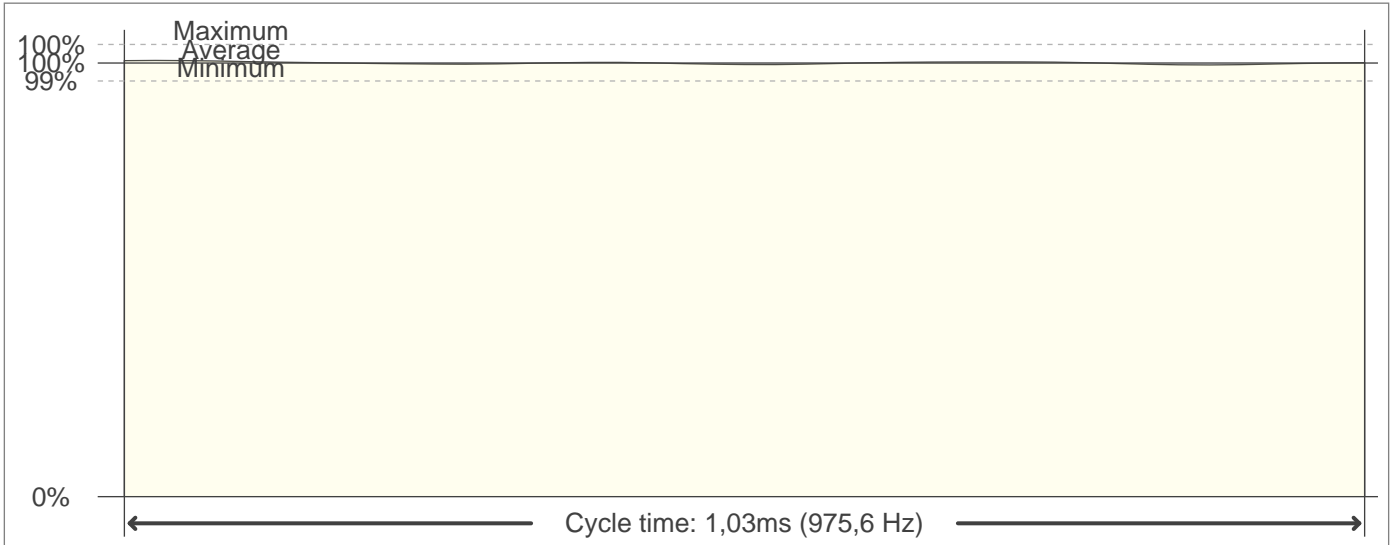

Flicker FFT (frequency scope of flicker curve)

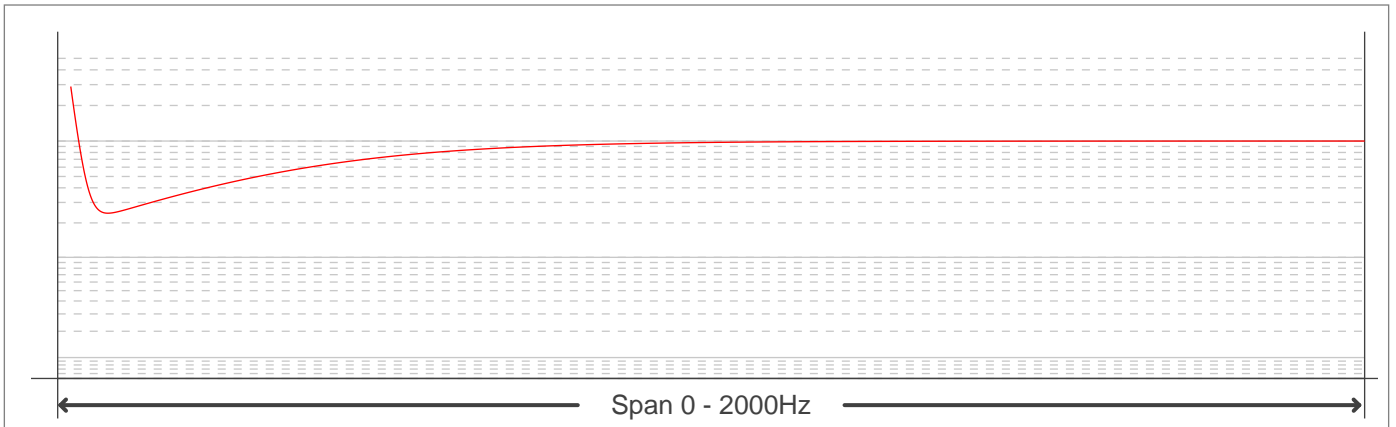

Flicker results:

Flicker frequency:	975,61 Hz
Flicker index:	0
Flicker percentage:	1,2 %
SVM: (Visual flicker)	0

Flicker conditions:

Sample Rate	40000 samples/second
-------------	----------------------